



Patented

Fry Top with indirect heating dual control

DATASHEET

Length (mm): 1200
 Depth (mm): 800
 Height (mm): 250/460
 Net weight (kg): 155,5
 Packed unit weight (kg): 195,5
 Pallets size (mm): 1300x900x670

Electrical power (kW): 9,6 kW
 Electrical connection:
 400V 3N 50-60 Hz
 Phase: 14,54 A

Cooking surface:

- mod GE1280L2C: flat
 - mod GE1280D2C: half ribbed
 - mod GE1280T2C: ribbed
- made of stainless steel thickness 10 mm with lateral edges and scotch brite back finish.

Available cooking surface L= 1194 mm D= 595 mm

Front dripping tray easily removable and washable
 Auto supporting structure completely made in stainless steel AISI 304, visible parts with scotch brite finish.

Adjustable plastic feet.

Heating made by resistances immersed in diathermic fluid inside a tank with expansion tank and safety valve.

Switch on/off button, cooking temperature control from 20°C to 260°C degrees by electronic thermostat.

Limit control with manual reset.

Accessories included: power cable, palette knife and kitchen scraper for cleaning.

Protection degree IPX4.
 CE Certification.

GE1280L2C

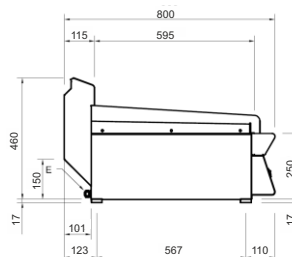
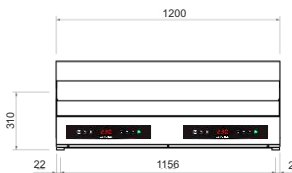
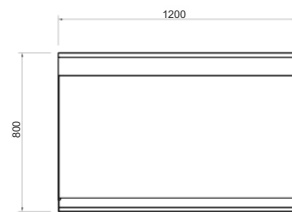
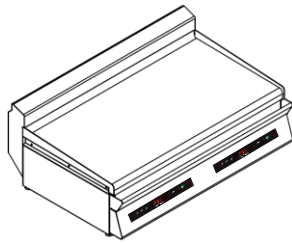

E= Electrical connection

GE1280D2C

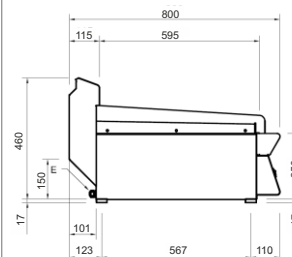
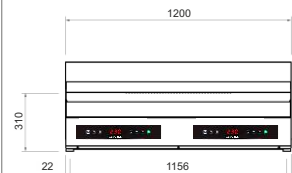
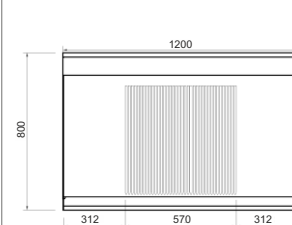
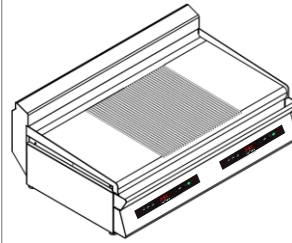

E= Electrical connection

GE1280T2C

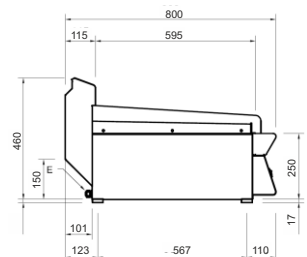
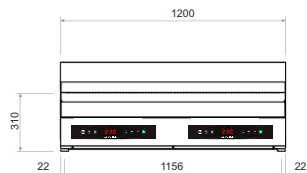
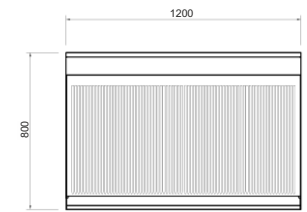
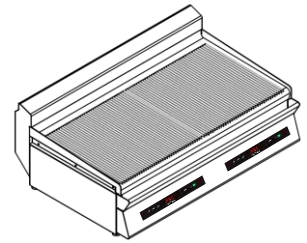

E= Electrical connection

ZERNIKE
 ALTERNATIVE HO.RE.CA. SOLUTIONS

GRUPPO ZERNIKE s.r.l.
 via del Progresso, 15
 47039 San Mauro Pascoli (FC) Italy
 Tel. +39 0541.810270-Fax +39 0541.937456
 info@zernike.it - www.zernike.it



UK and Ireland Distributor

MCS Technical Products
 Building 2 Westmead Industrial Estate
 Westmead Drive, Swindon, SN5 7YT
 Tel. +44 01793 538308
 Fax +44 01793 522324
 sales@mcstechproducts.co.uk www.mcstechproducts.co.uk